



Important Notes

ARRANGE FOR A SKILLED PERSON TO CARRY OUT THIS STEP!

- Only skilled persons may transport and set up the 159.
- The 159 and the associated lifting equipment are packed in a flight case for transport. Only transport the device in the tightly closed flight case.
- The lifting equipment supplied is not suitable for carrying the device. It is only used to lift the device out of the flight case.
- Only lift the device using the lifting equipment supplied.
- Due to its heavy weight, 5 people are required to set up the device. The load to be lifted per person is over 45 kg.
- Wear personal protective equipment when transporting and setting up the device.
- When selecting a suitable installation location, follow the instructions in the 159 operation manual.
- Make sure that there is sufficient space at the installation location to attach the lifting equipment and lift the device. Approximately 1 m of free space is required around the device at standing height.
- The 159 is ventilated through its underside. It is therefore not permitted to operate the 159 in its flight case.
- Keep this manual, the packaging and the lifting equipment for later transport of the device.



ATTENTION: DANGER DUE TO HIGH WEIGHT

Only persons who are experienced in handling heavy loads are permitted to handle the flight case containing the 159 and to set up the device.



ATTENTION: CRUSHING HAZARD TO HANDS AND FEET

Do not reach under the device when setting it up. Wear protective shoes and gloves when handling the flight case and setting up the device.

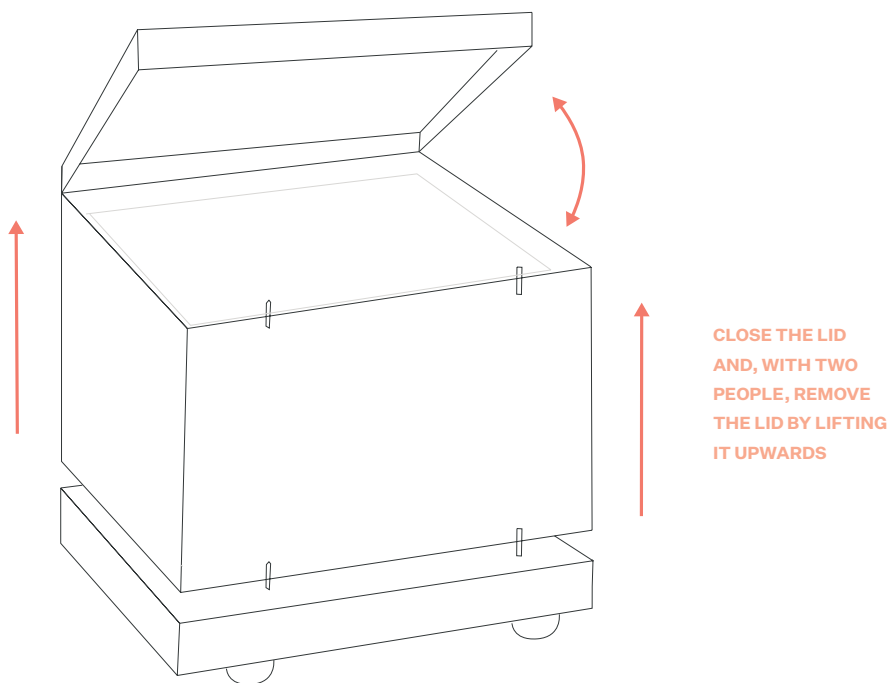

STEPS 1-4: UNPACKING

LEAVE THE PROTECTIVE COVER ON THE DEVICE!

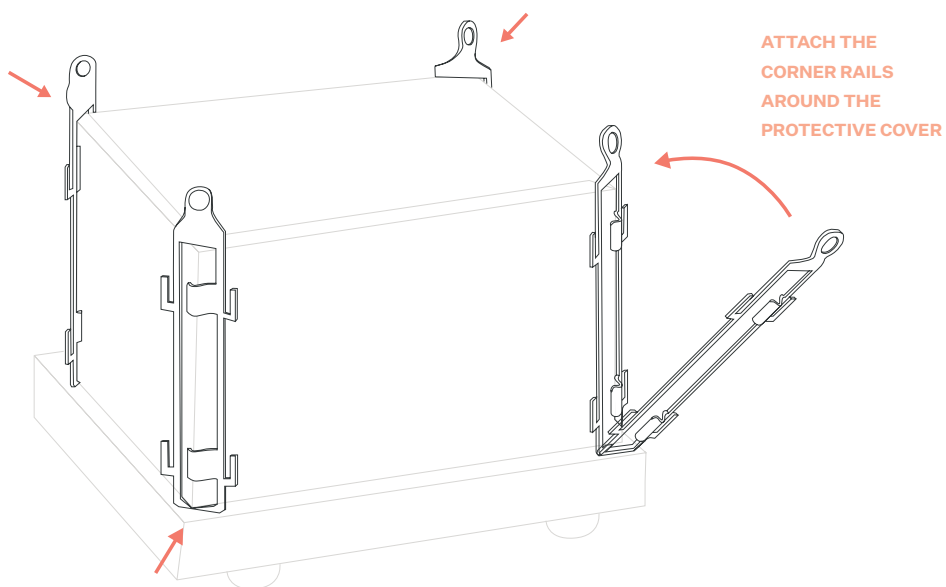

STEP 6: ATTACHING THE CORNER RAILS

Setting Up the Device

 **ARRANGE FOR A SKILLED PERSON TO CARRY OUT THIS STEP!**

1. Open the top section of the flight case.
(When a pair of 159s is delivered, one flight case contains the operation manual, warranty documents and the care kit, while the other flight case contains the lifting equipment.)
2. Remove all parts of the lifting equipment. It consists of 4 corner rails, 2 straps and 2 two-part lifting bars with a split pin for locking.
3. Re-close the top section of the flight case.
4. Open the bottom latches on the flight case and, with two people, carefully remove the lid by lifting it upwards.
5. With the device still in the base of the flight case, roll it to the desired installation location.
6. Attach the corner rails of the lifting equipment to the device as shown in the figure. You can mount the corner rails such that the lifting bars can be inserted either lengthwise or crosswise, depending on which option seems more practical at the installation location.

TO PROTECT THE AMPLIFIERS HOUSING FROM SCRATCHES DO NOT REMOVE THE PROTECTION COVER DURING SETUP!

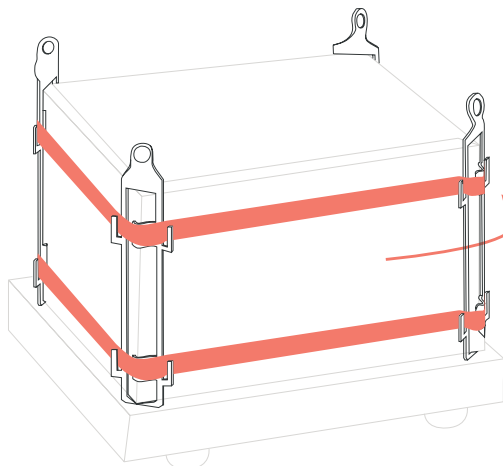

APPLY TOP AND BOTTOM STRAPS

STEP 7: ATTACHING THE STRAPS

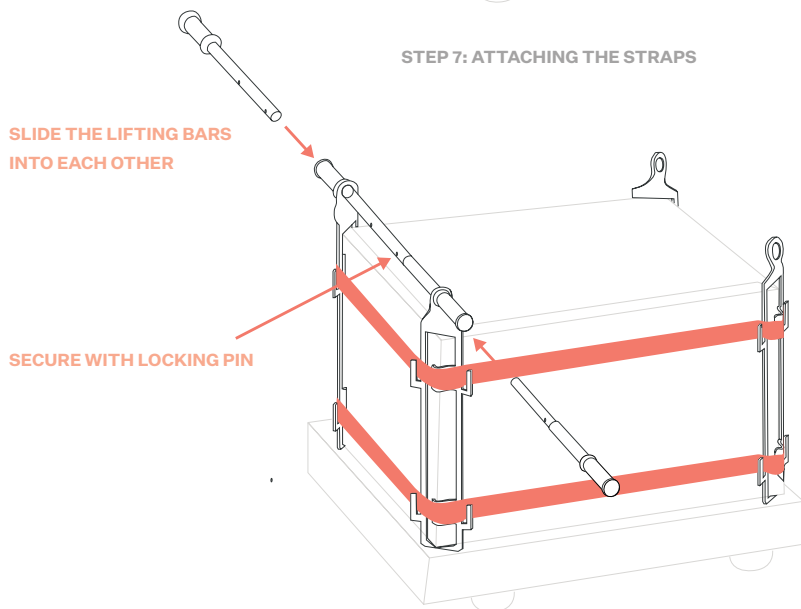

SLIDE THE LIFTING BARS INTO EACH OTHER

SECURE WITH LOCKING PIN

STEPS 8-9: ATTACHING THE LIFTING BARS

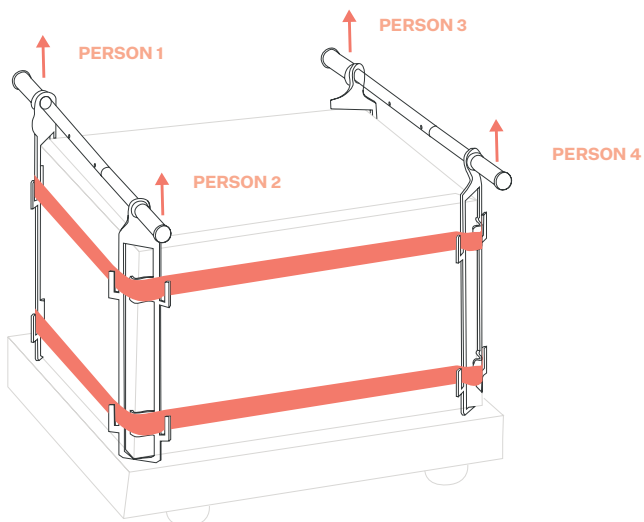

STEPS 10-13: LIFTING AND SETTING UP

7. Insert the supplied straps into the recesses in the corner rails and tighten them.
8. Two lifting bars form a pair and can be slid into each other. Insert two matching lifting bars into the openings in the corner rails from both sides and push them together as far as they will go.
9. Secure the two parts with the supplied locking pin.
10. Lift the device out of the bottom of the flight case with 4 people using the 4 handles on the lifting bars. Do not try to lift the device with 2 people.
11. Have a fifth person remove the bottom of the flight case. This person must not reach under the raised device!
12. Carefully set the device down in the installation location.
13. Remove the lifting equipment by performing assembly steps 6–9 in reverse order.
14. Remove the protective cover from the device.
15. Repack the lifting equipment and the protective cover in the flight case and save it for later transport.

FOLLOW THE INSTRUCTIONS IN THE OPERATION MANUAL WHEN CONNECTING AND STARTING UP THE 159.

Pure Sound

HANDMADE BY BURMESTER

BURMESTER HOME AUDIO GMBH

Wilhelm-Kabus-Straße 47

10829 Berlin

Germany

www.burmester.de

Burmester